

## Hippo Connector

### Strip Light Connector for Quick & Easy Connection

#### FEATURES

- Allow users to attach wire according to project requirement (wire color, cross section, length, etc)
- No need to stripping wire insulation when splicing flat ribbon cable
- No need to remove the surface coating layer of waterproof strip light
- Good for high-density light LED strip, the clear cover won't mask light of first LED.
- Gripping LED strip very firmly
- Safe material: UL94v-0 rated material



#### MODELS

Model NO.	Strip Light Type	Connection Type	IP Rating	Connecting Position
BOL-H-8SW-2	FS35 Series (8mm)	Strip to wire	IP20	Between strip and wire
BOL-H-8SS-2	FS35 Series (8mm)	Strip to strip joint	IP20	Between two strips, without wires
BOL-H-8SW-2-65	FS35 Series (8mm)	Strip to wire	IP65	Between strip and wire
BOL-H-8SS-2-65	FS35 Series (8mm)	Strip to strip joint	IP65	Between two strips, without wires
BOL-H-10SW-2	FS28 Series (10mm)	Strip to wire	IP20	Between strip and wire
BOL-H-10SS-2	FS28 Series (10mm)	Strip to strip joint	IP20	between two strips, without wires
BOL-H-10SW-4	FS50 Series RGB (10mm)	Strip to wire	IP20	Between strip and wire
BOL-H-10SS-4	FS50 Series RGB (10mm)	Strip to strip joint	IP20	Between two strips, without wires
BOL-H-12SW-5	FS50 Series RGBW (12mm)	Strip to wire	IP20	Between strip and wire
BOL-H-12SS-5	FS50 Series RGBW (12mm)	Strip to strip joint	IP20	Between two strips, without wires

#### DRAWING

Unit: mm

BOL-H-8SW-2:

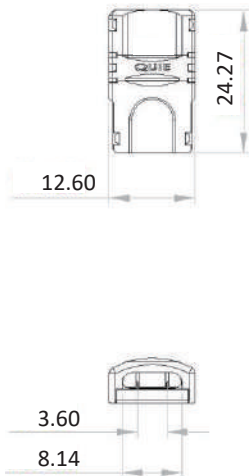

BOL-H-8SS-2:

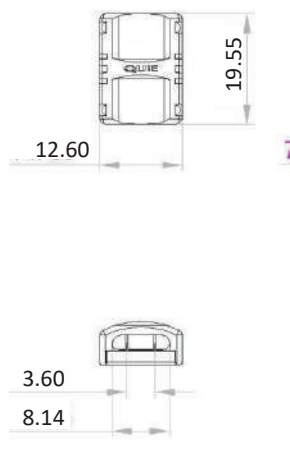

BOL-H-8SW-2-65:

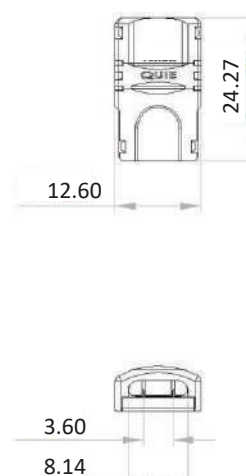

BOL-H-8SS-2-65:

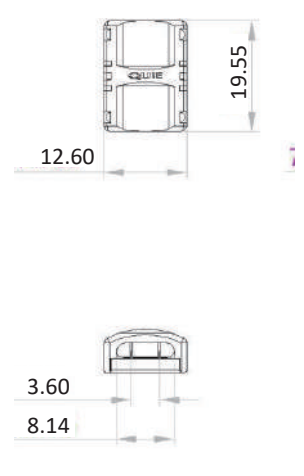

BOL-H-10SW-2:

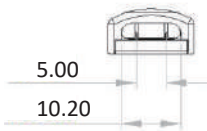

BOL-H-10SS-2:



BOL-H-10SW-4:

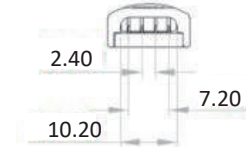
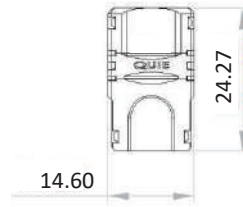

BOL-H-10SS-4:

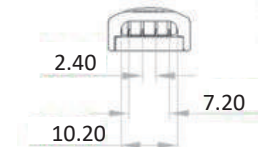

BOL-H-12SW-5:

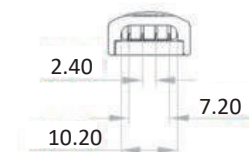
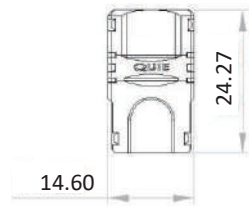

BOL-H-12SS-5:

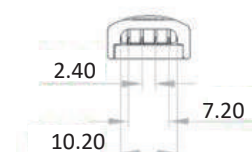

## INSTALLATION

Single Colour:



RGB:

